



The sealing tape for the exterior, directly exposed to weather – pintaband D600 BG1

The pintaband D600, according to DIN standard 18542 BG1, is a sealing tape consisting of impregnated foam. It serves for the primary sealing of seams and junctions directly exposed to weather.

It is heat insulating and sound absorbing, in addition to sealing against wind, dust and spray water, thereby reducing energy costs immediately and maintaining the value of the building structure.

Areas of application

- Window construction, interior construction
- Façade engineering (including natural stone)
- Thermo insulation composite system, latticework, wood and metal construction
- Pre-fabricated housing, container and roof construction (e.g. wind-tight bonding of foil), noise protection, etc.

Application sketch

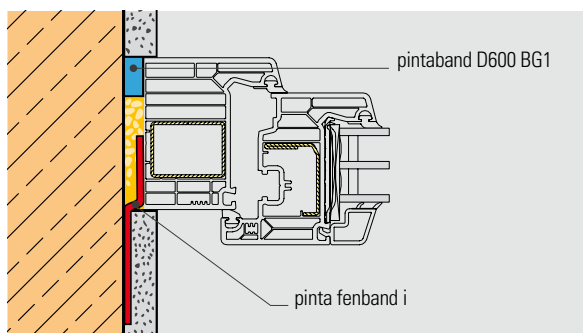

>> | Are you familiar with the alternative?

- pintaband B300 BG2 – the sealing tape for the interior and the exterior, according to DIN standard 18542 BG2, driving rain resistant up to 300 Pa, tested up to even 450 Pa

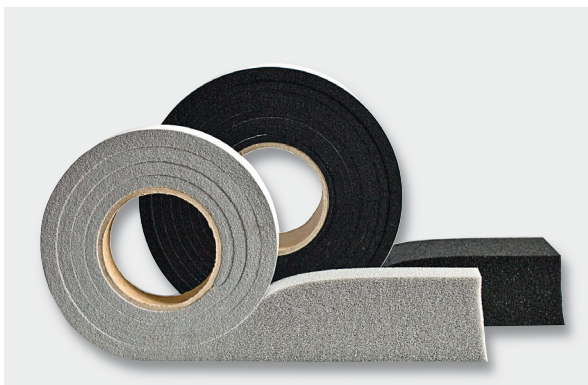

Colour / Delivery forms

- grey, black
- pre-compressed onto a roll
- not pre-compressed in strips of 2,00 m

Characteristics*

- heat insulating and sound absorbing (59 dB)
- compatible with adjoining building materials according to DIN 18542 BG1
- driving rain resistant ≥ 600 Pa
- open to vapour diffusion according to DIN 18542 BG1
- temperature-change resistance according to DIN 18542 BG1, tested from - 30 °C to +90 °C according to RAL-GZ 711
- resistant to the effects of light and moisture acc. DIN 18542 BG1
- Reaction to fire according to DIN 4102-1 B1, ABP-Nr. P-NDS04-850
- consistent quality guaranteed through regular third-party- and self-monitoring (MPA Hannover, ift Rosenheim)

Product advantages*

- seals against wind, dust and driving rain
- controlled expanding behaviour
- 10 years functional guarantee according to manufacturer's conditions**

* The characteristics are partially dependent on the amount of pressure applied. See separate handling and installation instructions.

** The manufacturer's conditions are available upon request.

Technical data

Characteristics	Classification	Norm
Foam base	Polyurethane flexible foam	
Basis of impregnation	special flame-resistant acrylate	
Joint permeability (a-value), air tightness	$a < 1.0 \text{ m}^3 / [\text{h} \cdot \text{m} \cdot (\text{daPa})^2]$	DIN EN 12114 DIN 18542
Driving rain resistance	DIN 18542 BG1 ≥ 600 Pa	DIN EN 1027
Temperature-change resistance	- 20 °C up to + 80 °C	DIN 18542 BG1
Compatibility with other building materials	Requirements fulfilled	DIN 18542 BG1
Construction material class/reaction to fire	B1 (low flammability), ABP-No. P-NDS04-850	DIN 4102-1
Water vapour permeability, SD-value	$< 0,5 \text{ m}$	EN ISO 12572
Joint sound absorption, ift regulations	$R_{ST, w, max} = 59 \text{ dB}$	SC-01/2:2002-09
Thermal conductivity	$\lambda = 0,046 \text{ W}/(\text{m} \cdot \text{K})$	DIN EN 12667
Heat transfer coefficient at a tape width of 75 mm	U-value = $0.56 \text{ W}/(\text{m}^2 \cdot \text{K})$	DIN EN 12667
Durability	10 years guaranteed according to manufacturer's warranty**	
Storage time	1 year at room temperature < 20 °C in original packaging	

The technical data may vary, depending on the degree of pressure applied.

Tape sizes / Delivery forms

Order identification	Strip width/joint depth [mm]	for joint width [mm]
9 / 2	9	2
10 / 2-3	10	2 – 3
15 / 2-3	15	2 – 3
20 / 2-3	20	2 – 3
10 / 3-5	10	3 – 5
15 / 3-5	15	3 – 5
20 / 3-5	20	3 – 5
10 / 3-7	10	3 – 7
15 / 3-7	15	3 – 7
20 / 3-7	20	3 – 7
15 / 4-8	15	4 – 8
20 / 4-8	20	4 – 8
15 / 5-10	15	5 – 10
20 / 5-10	20	5 – 10
25 / 5-10	25	5 – 10
15 / 7-12	15	7 – 12
20 / 7-12	20	7 – 12
25 / 7-12	25	7 – 12
25 / 9-15	25	9 – 15
30 / 9-15	30	9 – 15
25 / 10-18	25	10 – 18
30 / 10-18	30	10 – 18
30 / 14-24	30	14 – 24
40 / 14-24	40	14 – 24

Additional sizes available upon request. Dimensional tolerance according to DIN 7715 P3.

Copyright © pinta abdichtung gmbh. Manufacturer's specifications dated: 04/2017. Picture credits: P. 1 top left © Thierius Gracchus/Fotolia.com, p. 1 top right © Marco2811/Fotolia.com. The specifications are laboratory values, and may deviate from the actual values during installation. They do not guarantee any product properties. The detail diversity and combination possibilities cannot all be covered in this manual. (Alt. brochure). The user shall be obliged to obtain accurate information. A specific work result cannot be guaranteed, due to the lack of transparency of the working conditions. We recommend test applications to ensure best possible results. Previous editions become invalid with the issue of this data sheet. Our general terms and conditions apply. All rights are reserved to modify the product at any time in order to incorporate the latest technological progress and developments (31.10.2017).

>> | Contact details

- we gladly provide individual advice – please don't hesitate to call our service hotline

pinta abdichtung gmbh
Kreuzbreite 4
31675 Bückeberg, Germany
phone +49 (0) 57 22. 89 36 - 0
fax +49 (0) 57 22. 89 36 - 16
sales@pinta-abdichtung.com
www.pinta-abdichtung.com