



LIBRA H7 SCREW FIXING LIVING SETTINGS



LIBRA H7 SCREW FIXING



INSTALLATION UNDER THE CABINET TOP

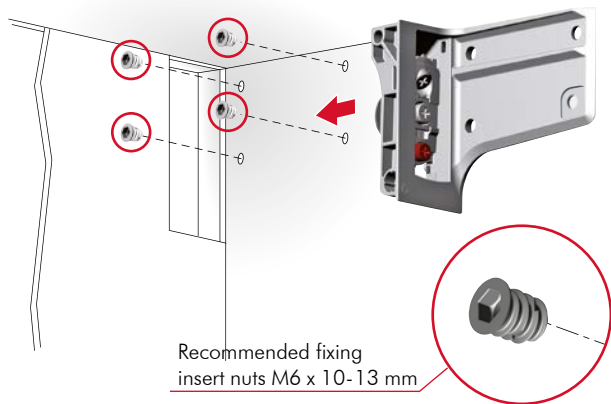

Recommended fixing flat head screws M6 x 12 mm

ALTERNATIVE APPLICATION WITHOUT TOP

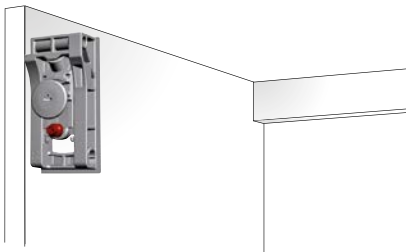

INSTALLATION ON THE WALL

- For details refer to "LIBRA WALL PLATES: LIBRA WP5"

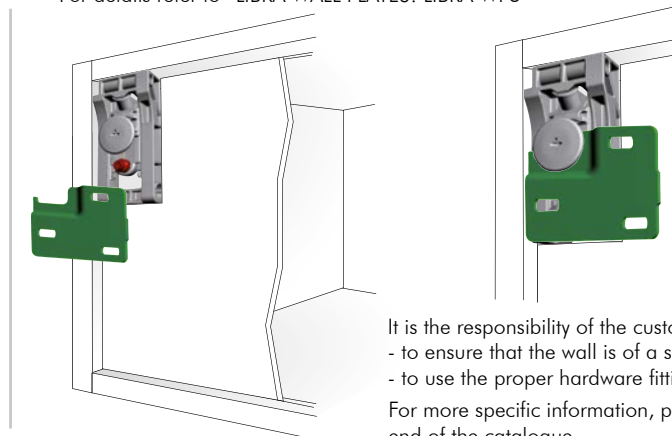

It is the responsibility of the customer:

- to ensure that the wall is of a suitable quality to hold the unit fixing in place.
- to use the proper hardware fittings according to the construction of the wall.

For more specific information, please refer to the WARNINGS section at the end of the catalogue.

ADJUSTMENTS

1
VERTICAL ADJUSTMENT
13 mm

2
IN-DEPTH ADJUSTMENT
12 mm

3
ANTI-TURNOVER LOCKING
Stop screwing the red bolt when it touches the wall plate



Slot for cross PZ2 screwdriver

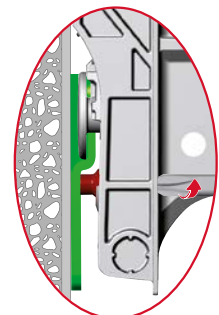
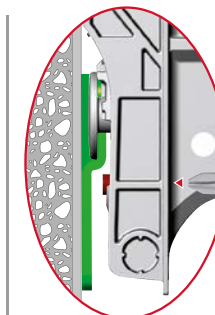
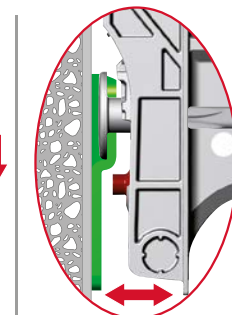
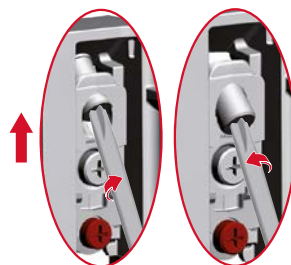
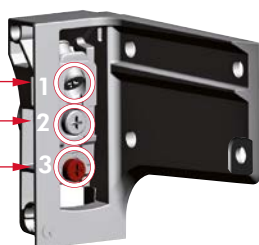

DRILLING PLAN WITH BACK PANEL WOOD THICKNESS 4 - 14 MM

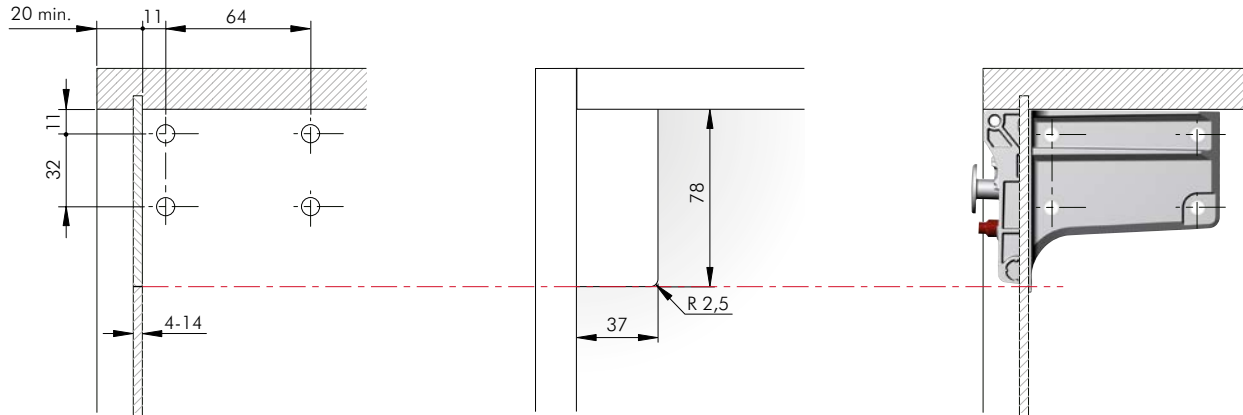

DRILLING PLAN WITHOUT BACK PANEL

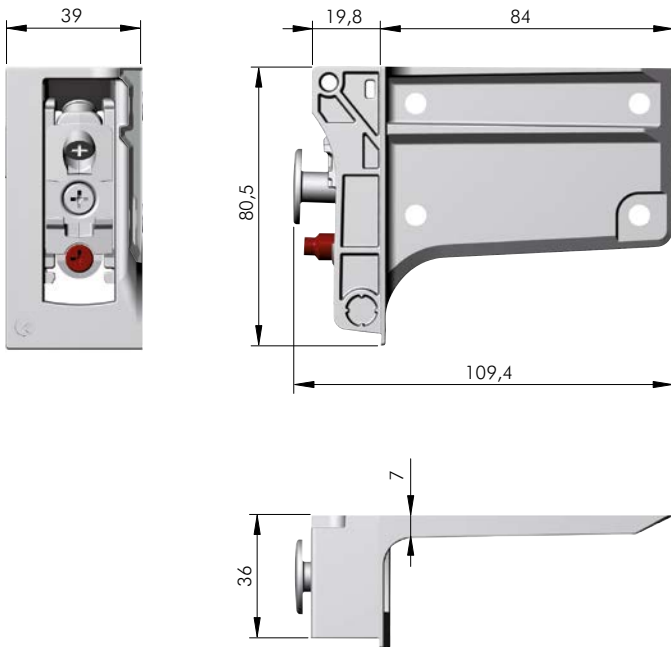
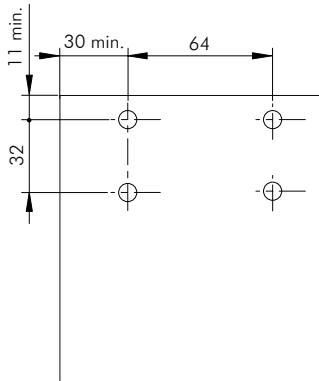

	= PZ2		= 50 pcs.
ZA	ST		
		R	
63422260ZN		L	
63422270ZN			

NOTE: for technical details about wall plates please refer to the related sections "LIBRA WALL PLATES" on page 12.65.

LIBRA H7 SCREW FIXING ACCESSORIES

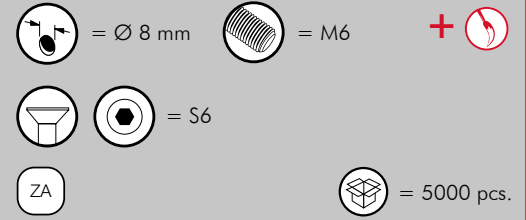
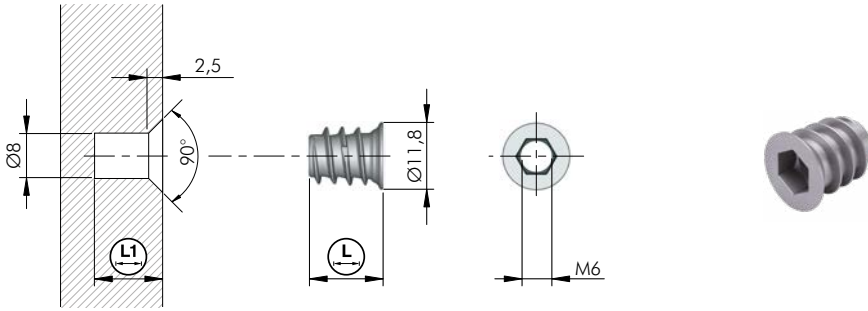

20102010GR		10	12
20102020GR		13	15

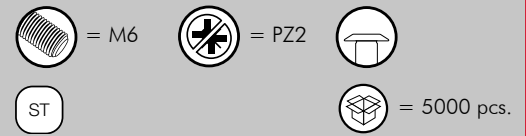

20819020ZN	



LIBRA H7 DOWEL FIXING WITH ALUMINIUM BAR LIVING SETTINGS



LIBRA H7 with H. 40,2 aluminium bar.
Ideal for bathroom cabinets.



LIBRA H7 with H. 80,5 aluminium bar.
Ideal for kitchen cabinets.

LIBRA H7 DOWEL FIXING WITH "PEG JOINT" FOR ALUMINIUM BAR



PATENTED

ASSEMBLING WITH OPTIONAL ALUMINIUM BAR H. 40,2 MM OR H. 80,5 MM

H. 40,2 MM ALUMINIUM BAR

Optional pre-drilled pilot holes

recommended fixing self-tapping pan head screws \varnothing 4,2 x 45 mm

H. 80,5 MM ALUMINIUM BAR

Optional pre-drilled pilot holes

Optional wood dowel \varnothing 8 x 30 mm

APPLICATION TO THE SUSPENDED BASE CABINET

Optional wood dowel \varnothing 8 x 30 mm

recommended fixing 3 pan head wood screws \varnothing 3,5 x 16 mm

Optional back panel 4-8 mm

Optional back panel 4 mm

INSTALLATION ON THE WALL

- For details refer to "LIBRA WALL PLATES: LIBRA WP5"



It is the responsibility of the customer:

- to ensure that the wall is of a suitable quality to hold the unit fixing in place.
- to use the proper hardware fittings according to the construction of the wall.

For more specific information, please refer to the WARNINGS section at the end of the catalogue.

ADJUSTMENTS (STEP 1)

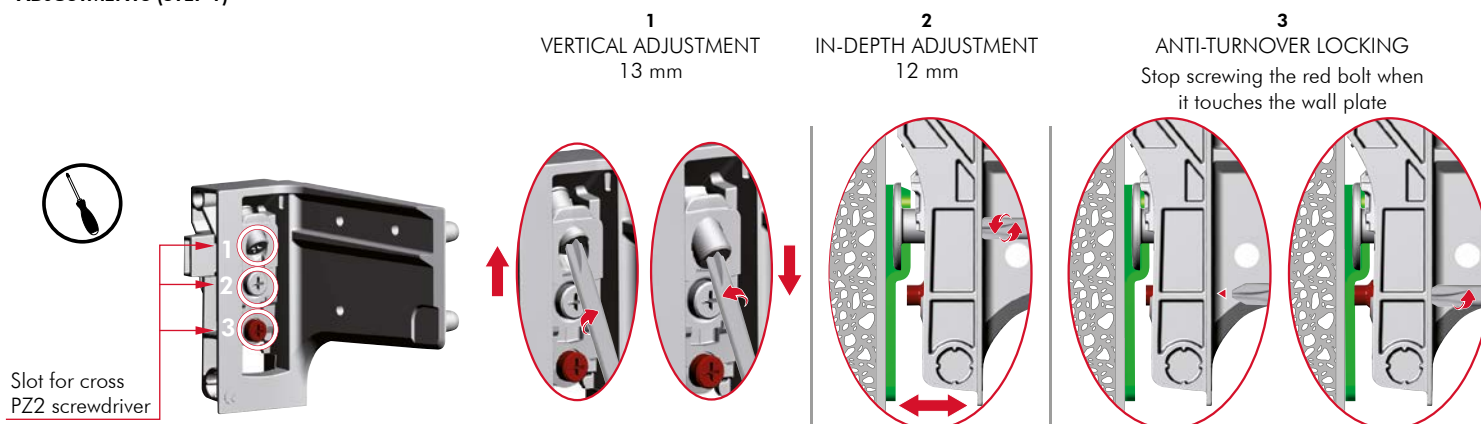

EXTRA HANGING POINTS (STEP 2)

The pre-drilled pilot holes ease the drilling operations on the wall.
Extra hanging points reduce the loading stress on the left/right wall plates.

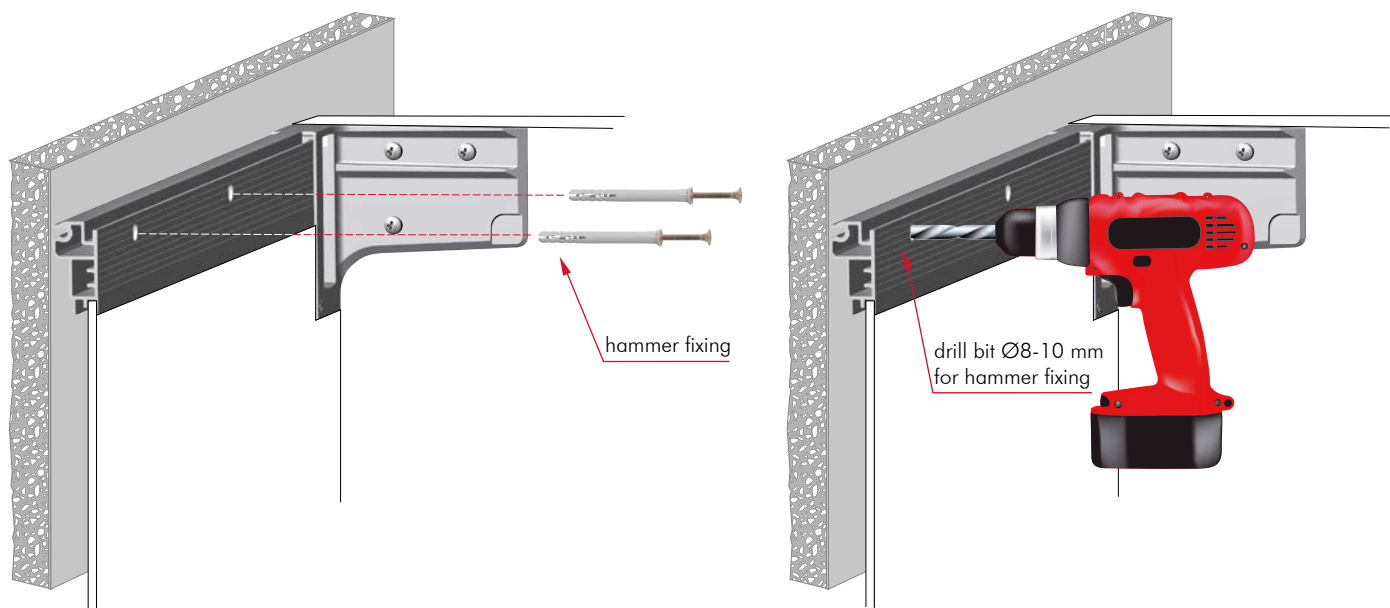

SIDE PANEL 15 MIN

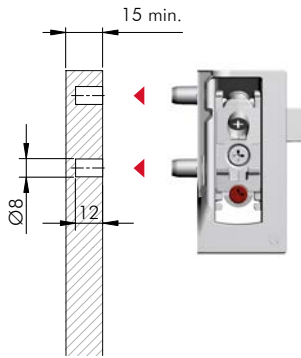

DRILLING PLAN WITHOUT BACK PANEL

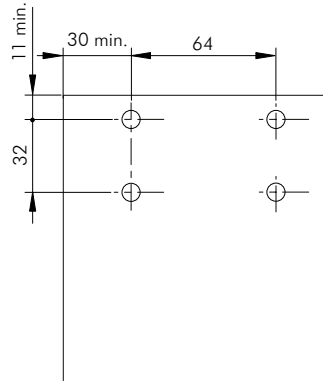

DRILLING PLAN WITH BACK PANEL WOOD THICKNESS 4 MM

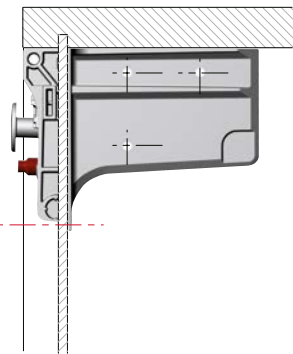
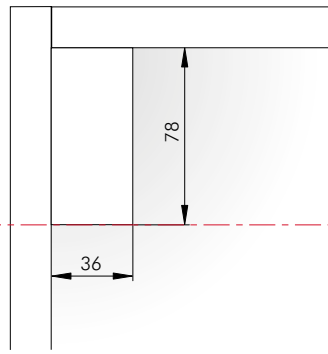
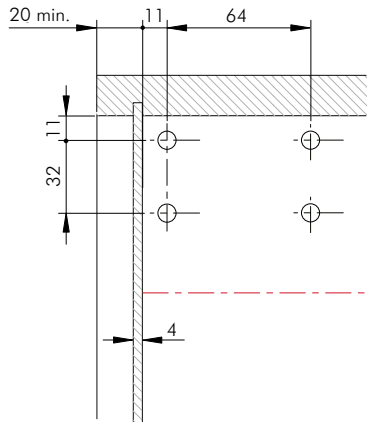

DRILLING PLAN WITH BACK PANEL WOOD THICKNESS 4 MM AND H. 40,2 MM ALUMINIUM BAR

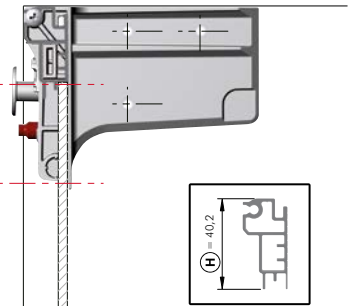
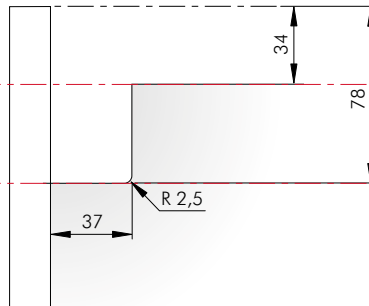
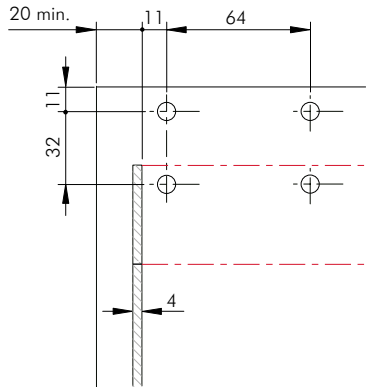

DRILLING PLAN WITH BACK PANEL WOOD THICKNESS 8 MM AND H. 40,2 MM ALUMINIUM BAR

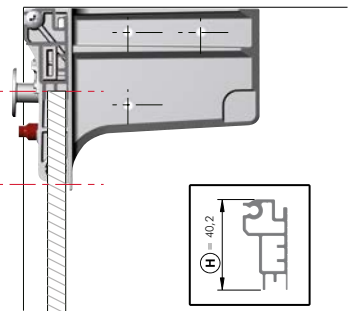
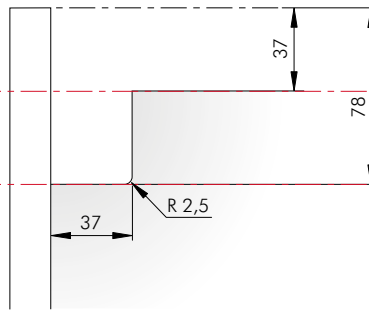
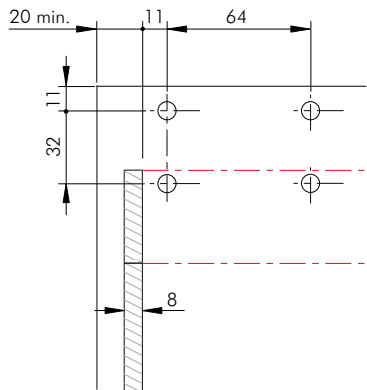

DRILLING PLAN WITH BACK PANEL WOOD THICKNESS 4 MM AND H. 80,5 MM ALUMINIUM BAR

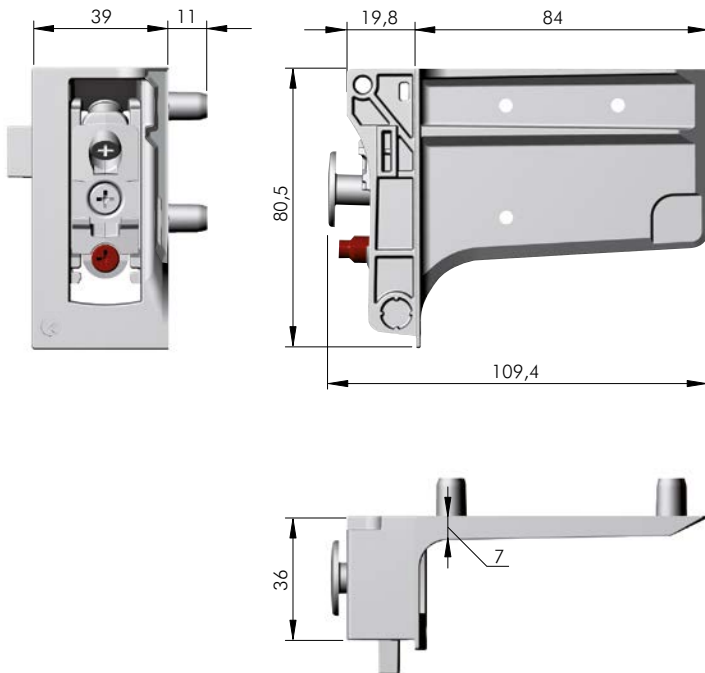
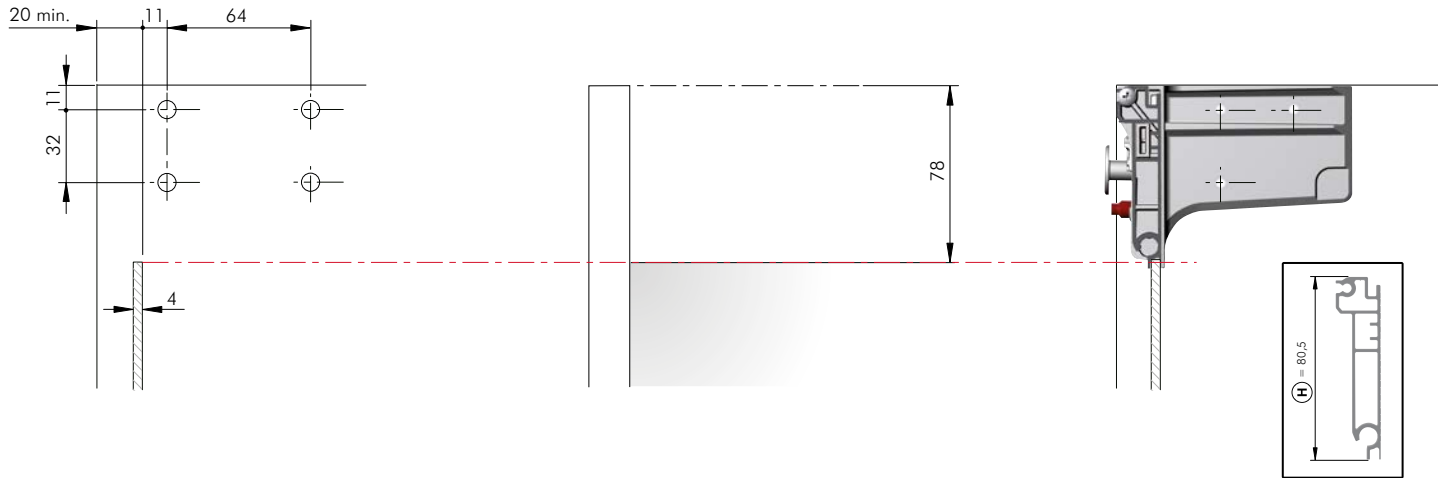

= PZ2			= 50 pcs.
12.3			
63422200ZN			
63422210ZN			

NOTE: for technical details about wall plates please refer to the related sections "LIBRA WALL PLATES" on page 12.65.

LIBRA H7 ALUMINIUM BAR H. 40,2

TO BE CUT BY THE CUSTOMER



AL	= on request		
12.3 6700000000	40,2	4000	

Optional pre-drilling operation/s to be carried out by the customer.

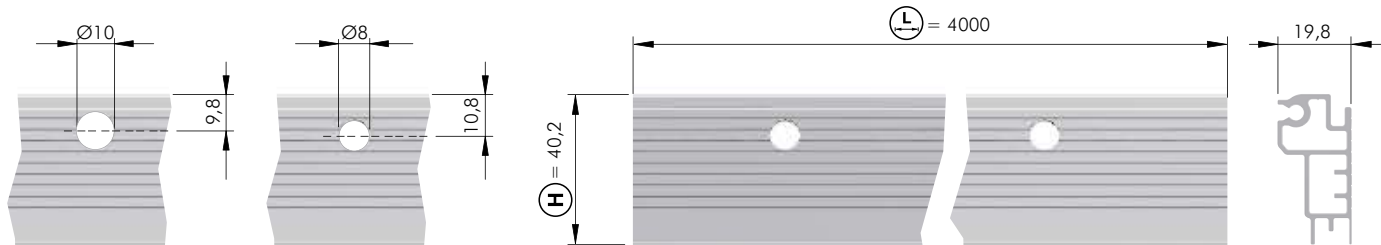

LIBRA H7 ALUMINIUM BAR H. 80,5

TO BE CUT BY THE CUSTOMER



AL	= on request		
12.3 6710000000	80,5	4000	

Optional pre-drilling operation/s to be carried out by the customer.

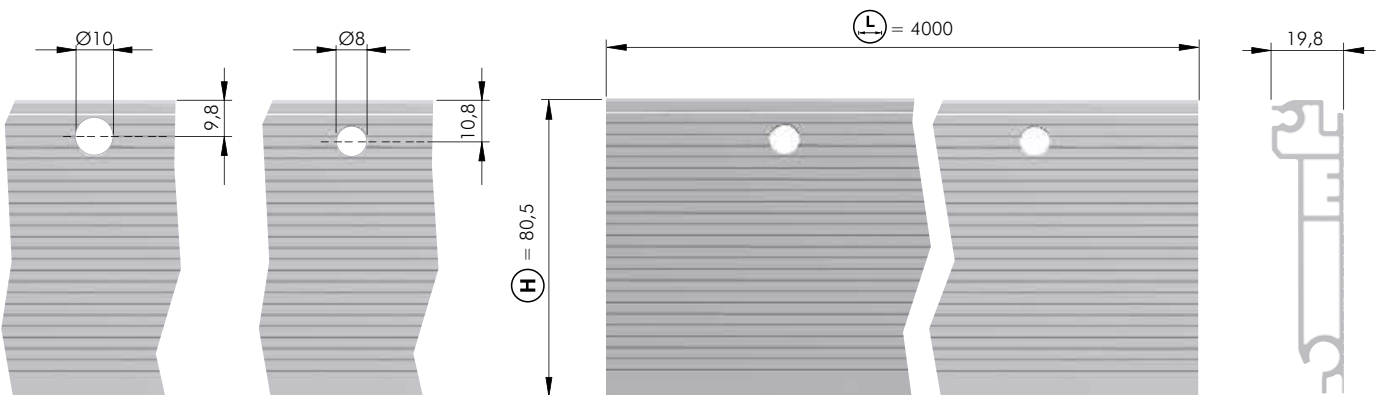



LIBRA H7 ALUMINIUM BAR H. 40,2 AND H. 80,5 WITHOUT END ELEMENTS

TO BE CUT BY THE CUSTOMER

SUGGESTED POSITIONING OF PRE-DRILLED Ø 8 OR Ø 10 INTERMEDIATE PILOT HOLES ACCORDING TO CABINET WIDTH

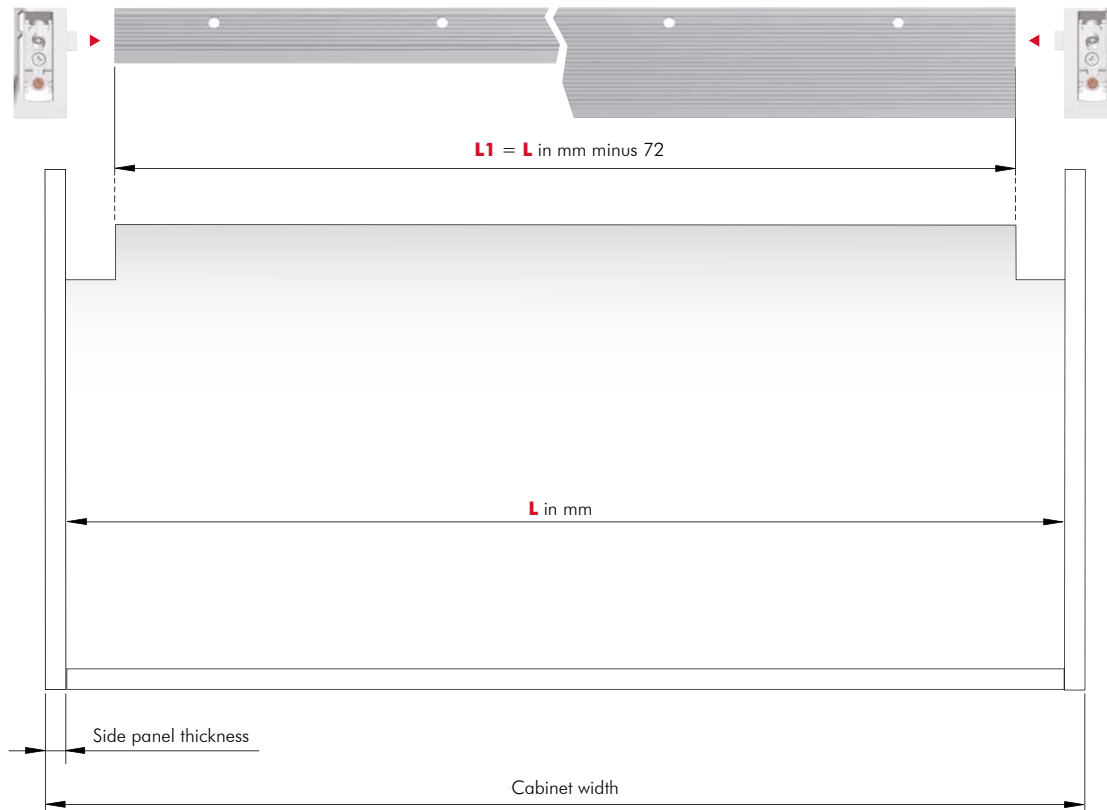

SUGGESTED COMBINATIONS:

CABINET WIDTH (mm)	INTERMEDIATE PILOT HOLES
up to 450	-
from 451 to 600	1
from 601 to 950	2
from 951 to 1200	3
over 1201	4

Cabinet width over 1201

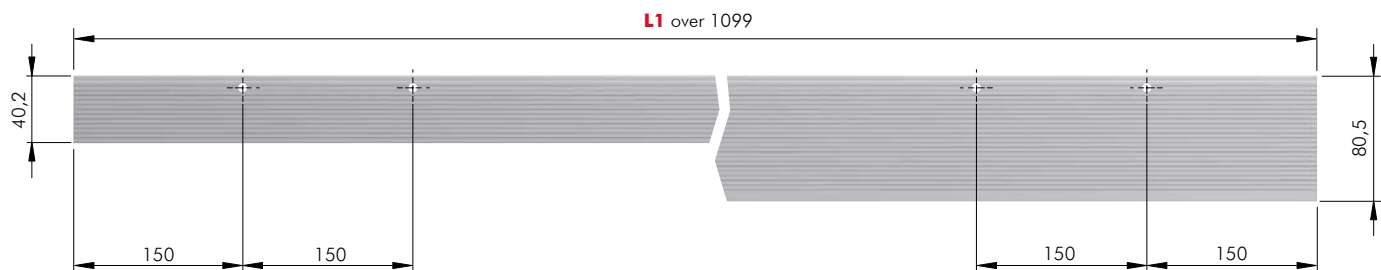

CABINET WIDTH OVER 1201

SIDE PANEL	L1
15	1099
16	1097
18	1093
19	1091

Cabinet width from 951 to 1200

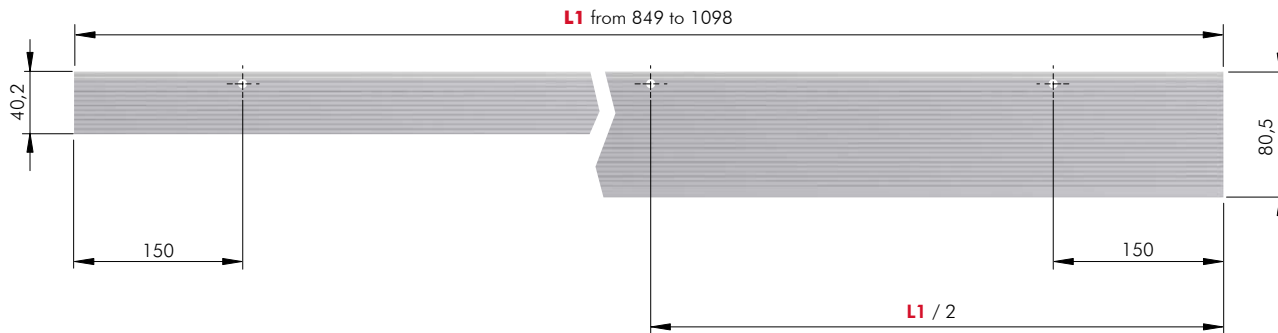

CABINET WIDTH from 951 to 1200

SIDE PANEL	FROM - TO
15	849 - 1098
16	847 - 1096
18	843 - 1092
19	841 - 1090

Cabinet width from 601 to 950

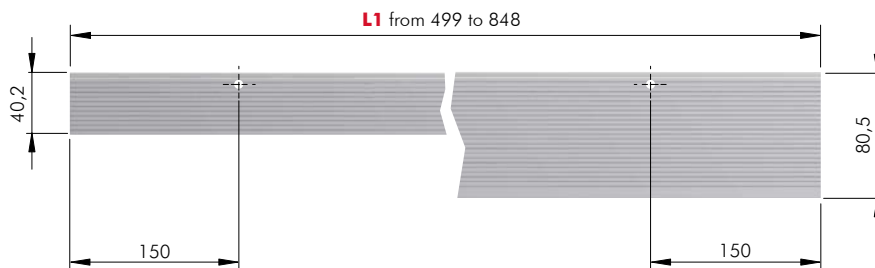

CABINET WIDTH from 601 to 950

SIDE PANEL	FROM - TO
15	499 - 848
16	497 - 846
18	493 - 842
19	491 - 840

Cabinet width from 451 to 600

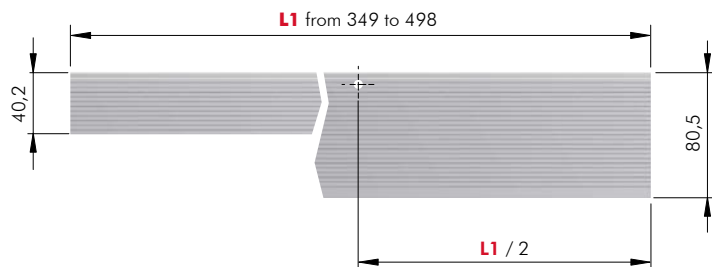

CABINET WIDTH from 451 to 600

SIDE PANEL	FROM - TO
15	349 - 498
16	347 - 496
18	343 - 492
19	341 - 490

Cabinet width 450

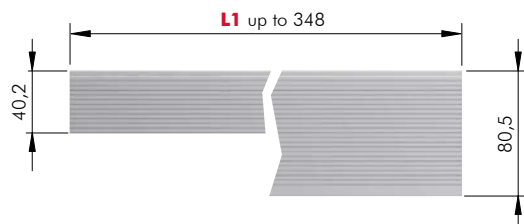

CABINET WIDTH 450

SIDE PANEL	L1
15	348
16	346
18	342
19	340

LIBRA H7 ALUMINIUM BAR H. 40,2 WITHOUT END ELEMENTS: CUT ON SIZE WITH PRE-DRILLED Ø 8 INTERMEDIATE PILOT HOLES

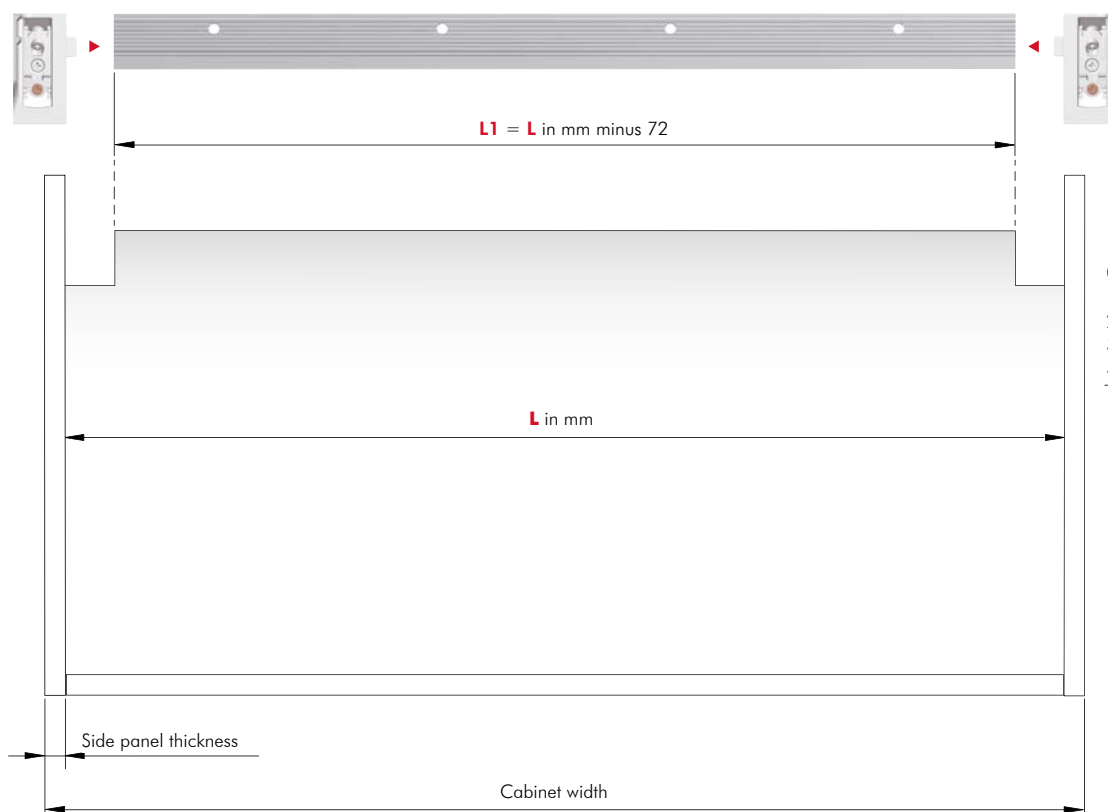

L1
670XXXXY00

- 0 = without intermediate pilot hole
- 1 = with 1 intermediate pilot hole
- 2 = with 2 intermediate pilot holes
- 3 = with 3 intermediate pilot holes
- 4 = with 4 intermediate pilot holes

SUGGESTED COMBINATIONS:

CABINET WIDTH (mm)	INTERMEDIATE PILOT HOLES
up to 450	-
from 451 to 600	1
from 601 to 950	2
from 951 to 1200	3
over 1201	4

LIBRA H7 ALUMINIUM BAR H. 80,5 WITHOUT END ELEMENTS: CUT ON SIZE WITH PRE-DRILLED Ø 8 INTERMEDIATE PILOT HOLES

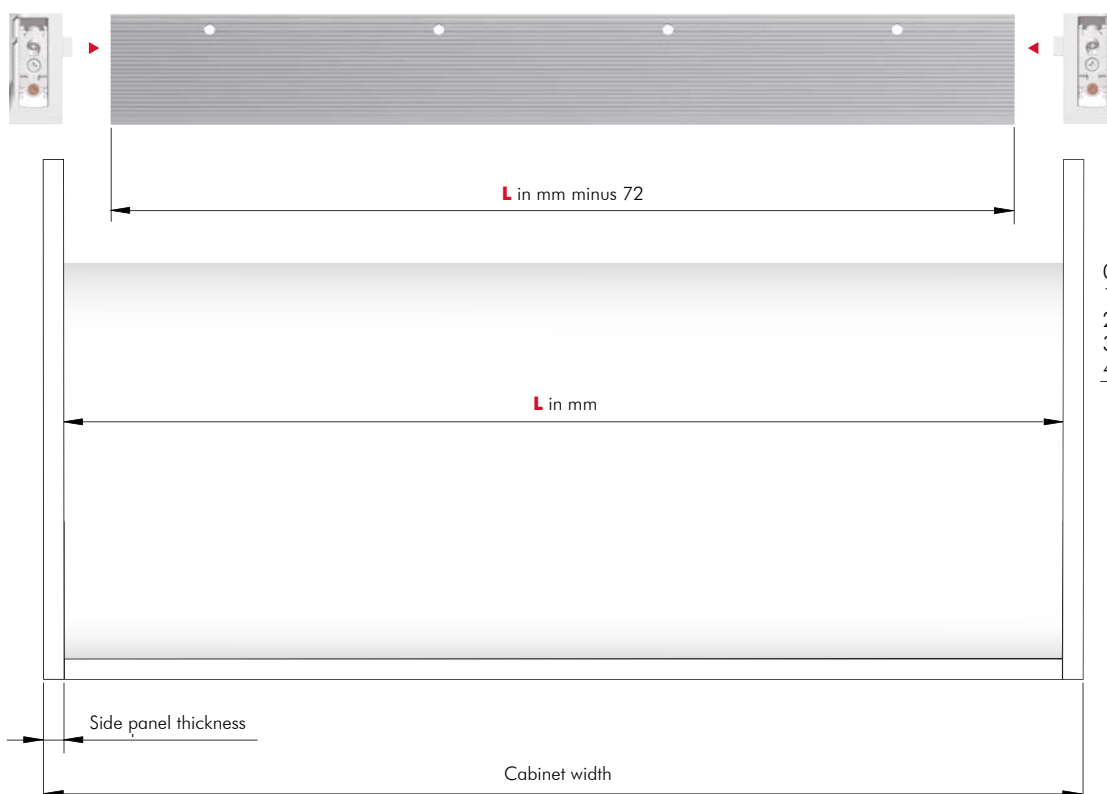

L in mm minus 72
671XXXXY00

- 0 = without intermediate pilot hole
- 1 = with 1 intermediate pilot hole
- 2 = with 2 intermediate pilot holes
- 3 = with 3 intermediate pilot holes
- 4 = with 4 intermediate pilot holes

SUGGESTED COMBINATIONS:

CABINET WIDTH (mm)	INTERMEDIATE PILOT HOLES
up to 450	-
from 451 to 600	1
from 601 to 950	2
from 951 to 1200	3
over 1201	4

LIBRA H7 DOWEL FIXING ACCESSORY

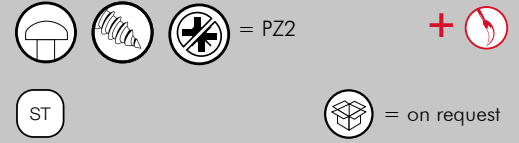
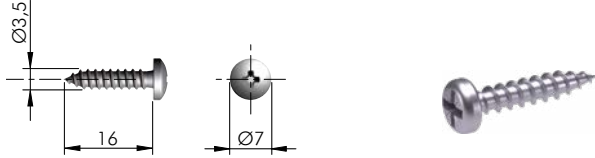

60103140ZN

LIBRA H7 H. 40,2 AND H. 80,5 ALUMINIUM BAR FIXING ACCESSORY

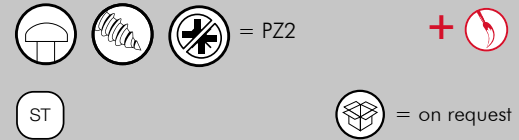
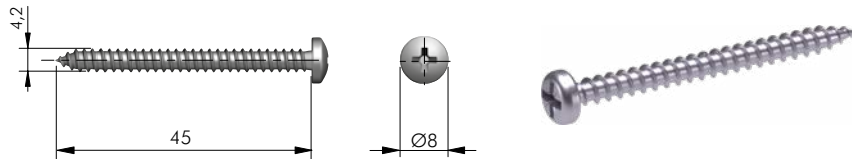

60203540ZN

LIBRA H7 H. 80,5 ALUMINIUM BAR FIXING ACCESSORY

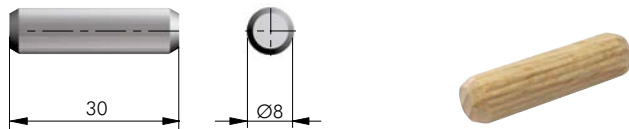

6110001000

OPTIONAL VERSION

LIBRA H7 SCREW FIXING WITH "PEG JOINT" FOR ALUMINIUM BAR



Certificates available on request.

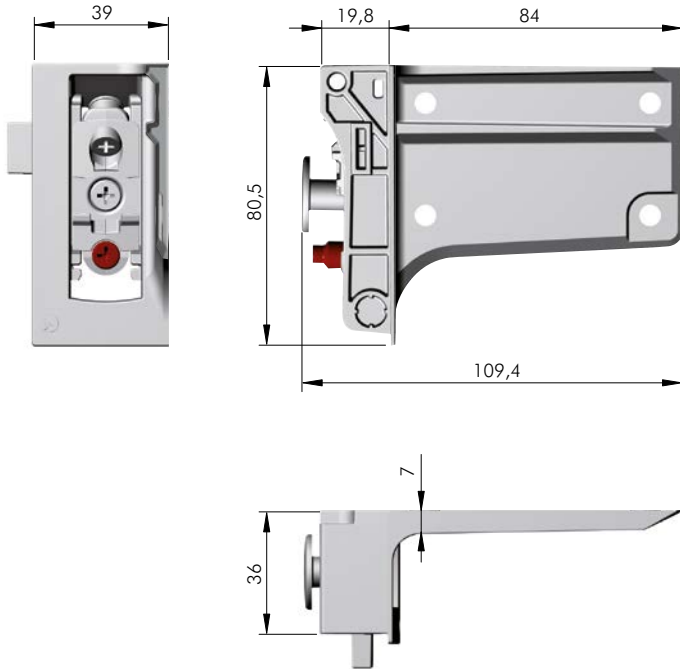

	= PZ2				= 50 pcs.
		63422240ZN	(R)		
		63422250ZN	(L)		

NOTE: for technical details about wall plates please refer to the related sections "LIBRA WALL PLATES" on page 12.65.

SIDE PANEL 15 - 16 MM THICK

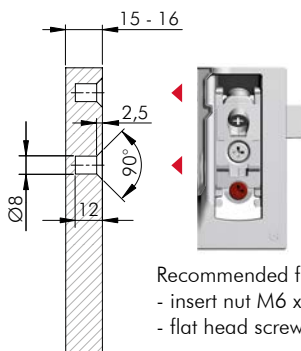

Recommended fixing accessories:
 - insert nut M6 x 10 mm
 - flat head screw M6 x 12 mm

SIDE PANEL 18 - 19 MM THICK

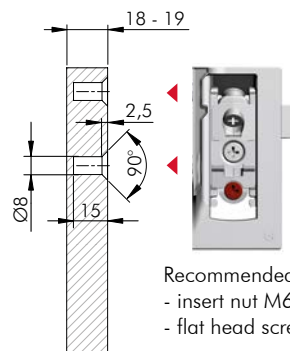

Recommended fixing accessories:
 - insert nut M6 x 13 mm
 - flat head screw M6 x 12 mm

DRILLING PLAN WITHOUT BACK PANEL

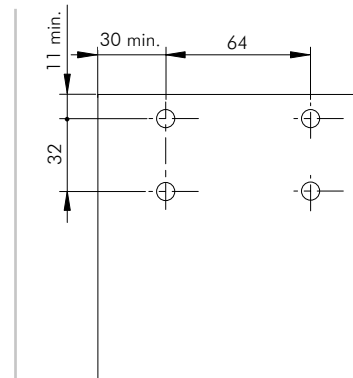

DRILLING PLAN WITH BACK PANEL WOOD THICKNESS 4 MM

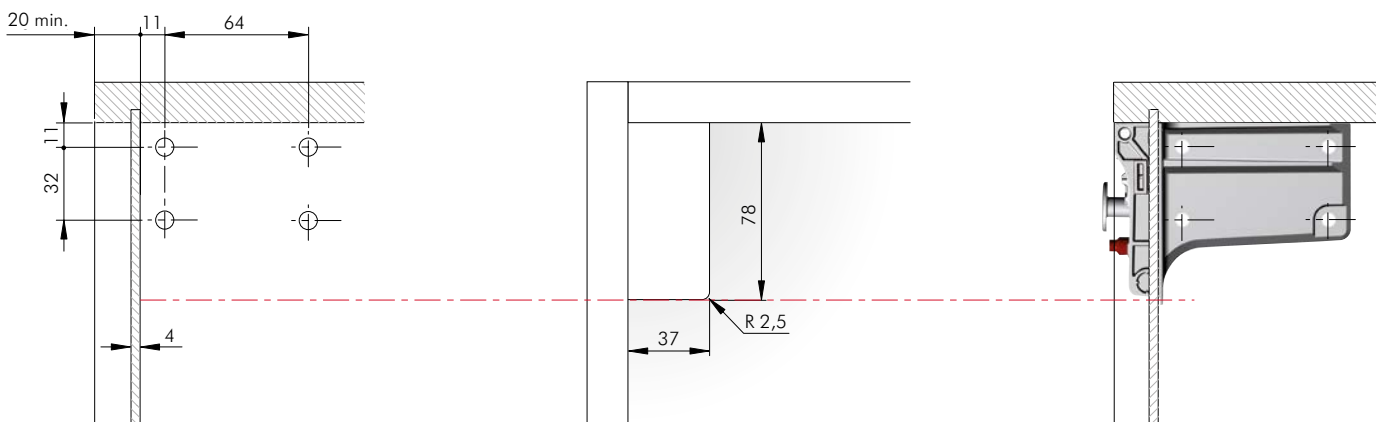

DRILLING PLAN WITH BACK PANEL WOOD THICKNESS 4 MM AND H. 40,2 MM ALUMINIUM BAR

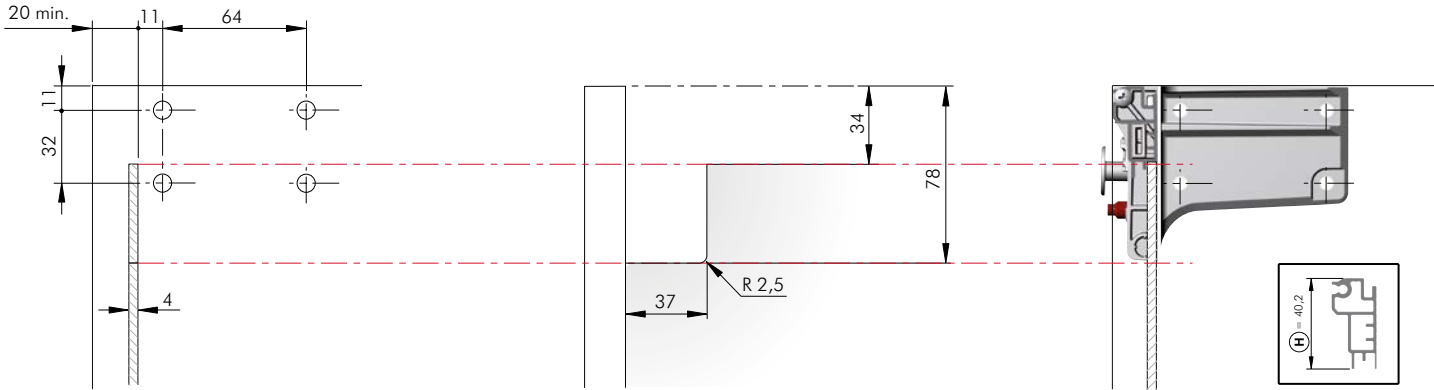

DRILLING PLAN WITH BACK PANEL WOOD THICKNESS 8 MM AND H. 40,2 MM ALUMINIUM BAR

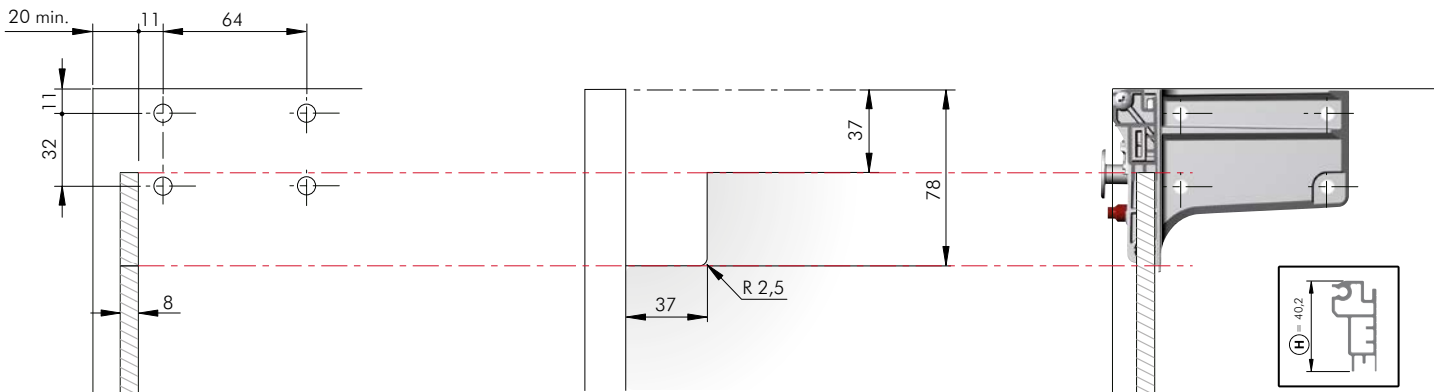

DRILLING PLAN WITH BACK PANEL WOOD THICKNESS 4 MM AND H. 80,5 MM ALUMINIUM BAR

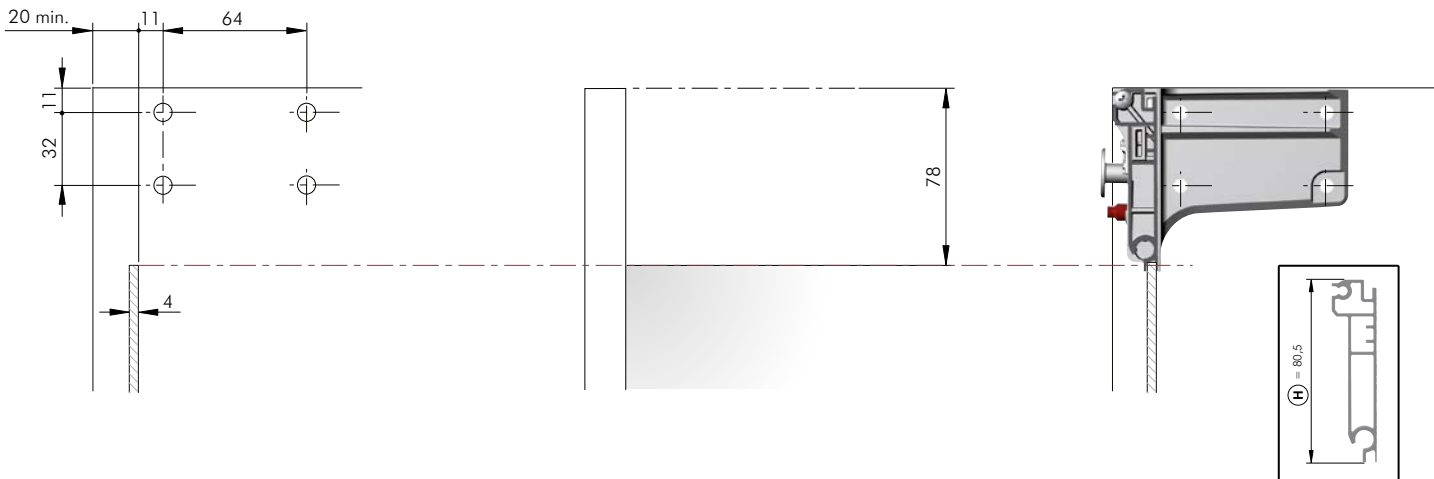



OPTIONAL VERSION

LIBRA H7 DOWEL FIXING WITHOUT "PEG JOINT"

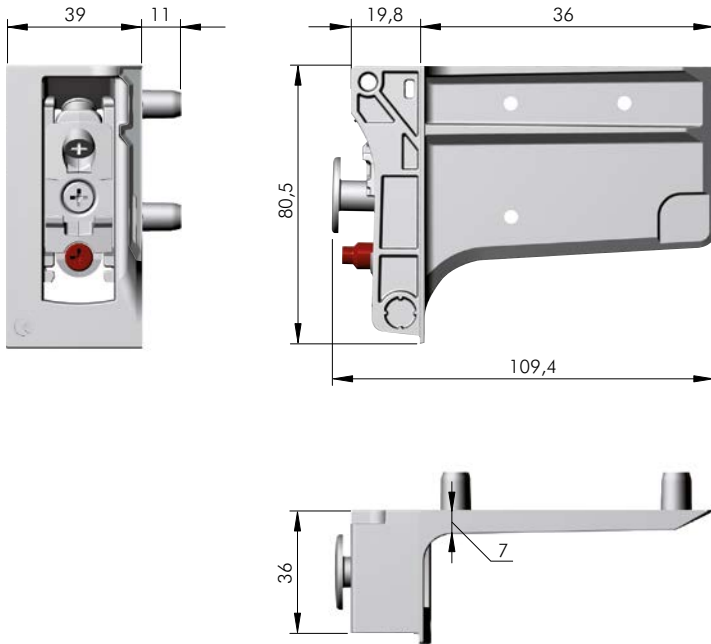

	= PZ2		= 50 pcs.
63422220ZN			
63422230ZN			

NOTE: for technical details about wall plates please refer to the related sections "LIBRA WALL PLATES" on page 12.65.

SIDE PANEL 15 MIN

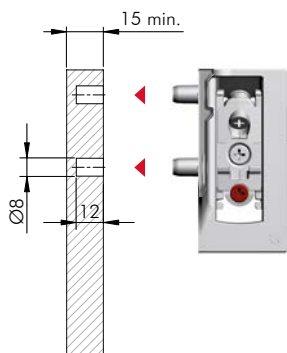

DRILLING PLAN WITHOUT BACK PANEL

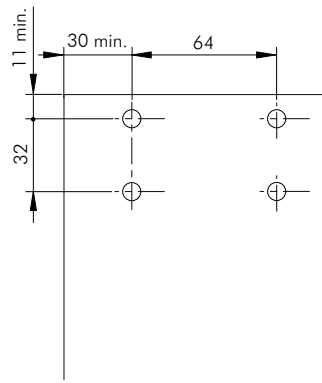

DRILLING PLAN WITH BACK PANEL WOOD THICKNESS 4 - 14 MM

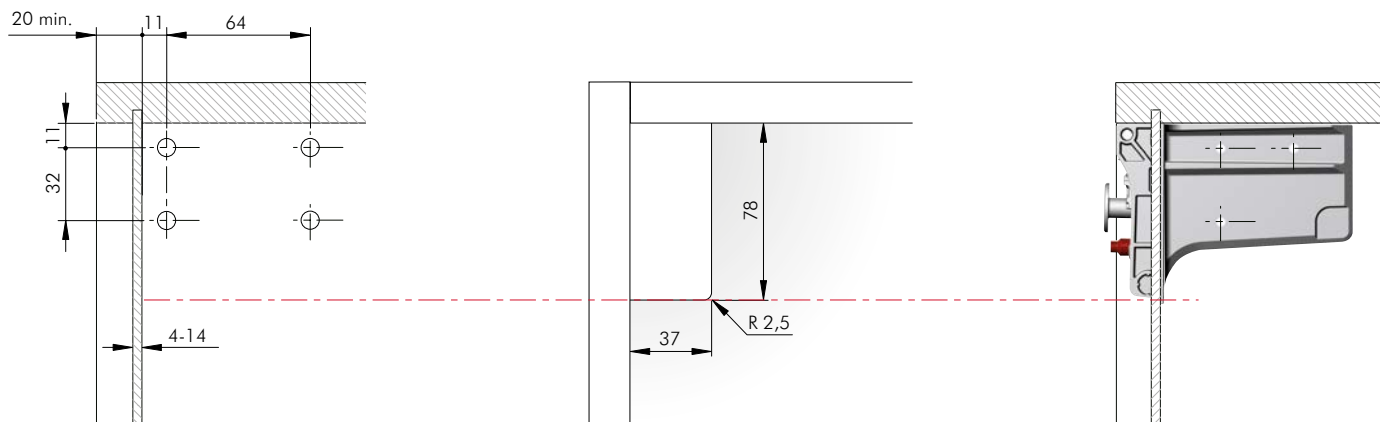

LIBRA H7 COVER CAPS LIBRA H7 INTEGRAL COVER

INSTALLATION

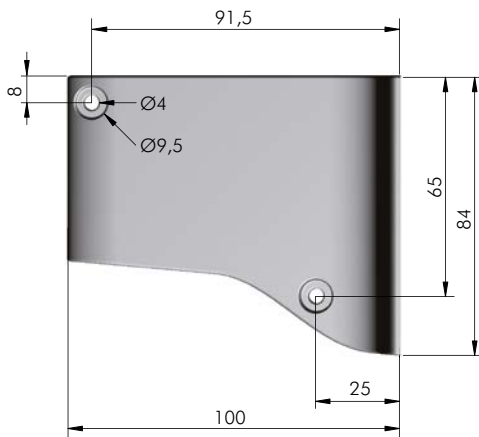

EP	= 200 pcs.	
63490620AB	(R)	
63490610AB	(L)	
63490620EE	(R)	
63490610EE	(L)	
63490620IJ	(R)	
63490610IJ	(L)	

COVER CAP FOR LIBRA H7 ADJUSTMENTS

INSTALLATION

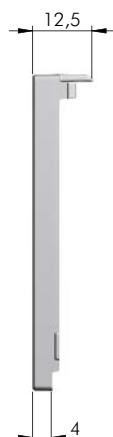
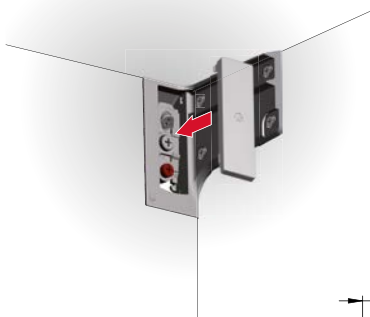

EP	= 1000 pcs.	
63490600AB		
63490600EE		
63490600IJ		



LIBRA H7 and LIBRA CH LIVING SETTINGS



LIBRA H7



LIBRA CH