

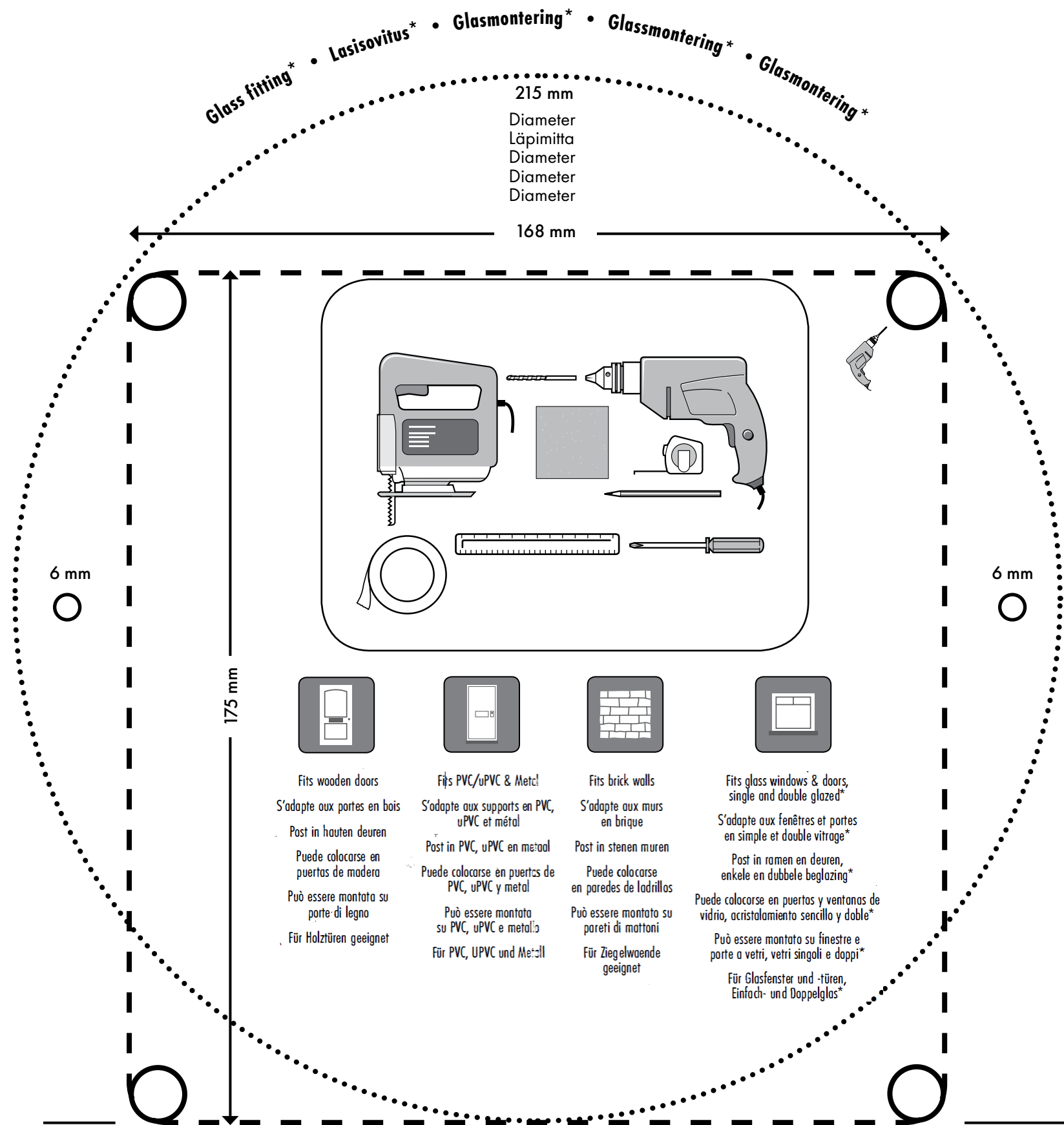

protect. teach. love.™

Cutting Template - Manual-Locking Cat Flap
Leikkausmalli - Manuaalisesti lukittava kissanluukku
Tillskärningsmall - Kattlucka med manuell
Skjæremal - Katteluke med manuell
Skæreskabelon - Manuel kattelem



Belly Height (X)
Mahan maavara (X)
Maghöjd (X)
Magehøyde (x)
Mavehøjde (X)

EN For detailed fitting instructions, please refer to the Programming and Installation Guide.

WARNING * It is not possible to cut holes in toughened glass or double glazed units except at the time of manufacture. Please consult a glazier. The PetSafe™ Manual-Locking Cat Flap is also designed for installation into glass and requires a circular hole with a diameter of 215 mm and an Installation Adaptor (sold separately).

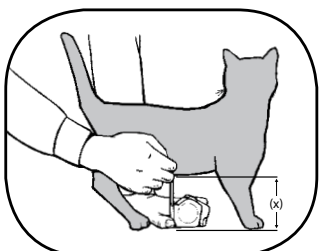

Belly Height (X)
Measure pet belly height. On the **OUTSIDE** of your door mark height on your door (X).

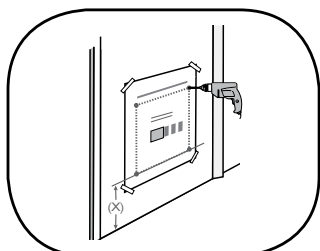

Position the cutting template base at belly height marked on door (X). Drill holes at corners as indicated.

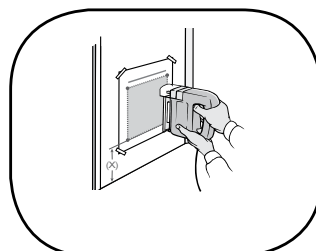

Using a jig or key-hole saw cut along the cutting line as indicated.

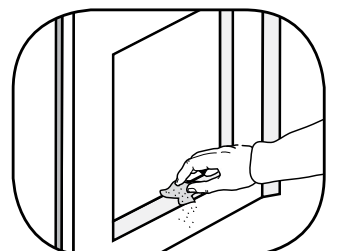

Smooth out any rough edges with sand paper or a file. Refer to the Quick Start Guide for fitting.